

Carrier with Loading Ramp Instruction Manual



Please read this instruction manual carefully before use.

WARNING!

A warning indicates a potentially dangerous situation, which if not avoided, could result in death or serious injury.

1. Read all instructions and save them for future reference.
2. Follow all warnings and instructions marked on the product.
3. Do not ride any vehicle while loading onto the carrier.
4. Do not stand on the carrier.
5. Never exceed vehicle tongue weight ratings.
6. Always store the carrier in a safe place.
7. Only use the carrier with Class III or IV hitch.
8. Improper use, storage or installation of carrier could result in death or serious injury.
9. Do not put the product on any kinds of trailers.
10. Carrying capacity is limited to 500 lbs. max.

Next loosen the bolts on the anti-tilt lock bracket. (There should be grooves where the bolts were tightened against the hitch receiver)

This procedure is required only during the initial installation of the anti-tilt lock bracket as for the grooves will ensure repeated relocating of the anti-tilt lock bracket. Now pull the carrier out to its final location and install the hitch pin. Return the anti-tilt lock bracket to the location securely against the hitch receiver and torque the bolts.

**THE BOLTS SHOULD FALL INTO THE GROOVES
CREATED EARLIER IN THIS PROCEDURE.**

ATTENTION:

Large chain loops on trailer hitches will not accept the anti-tilt locking device. In this case you will be unable to use the supplied anti-tilt locking device.



EXPLODED DRAWING

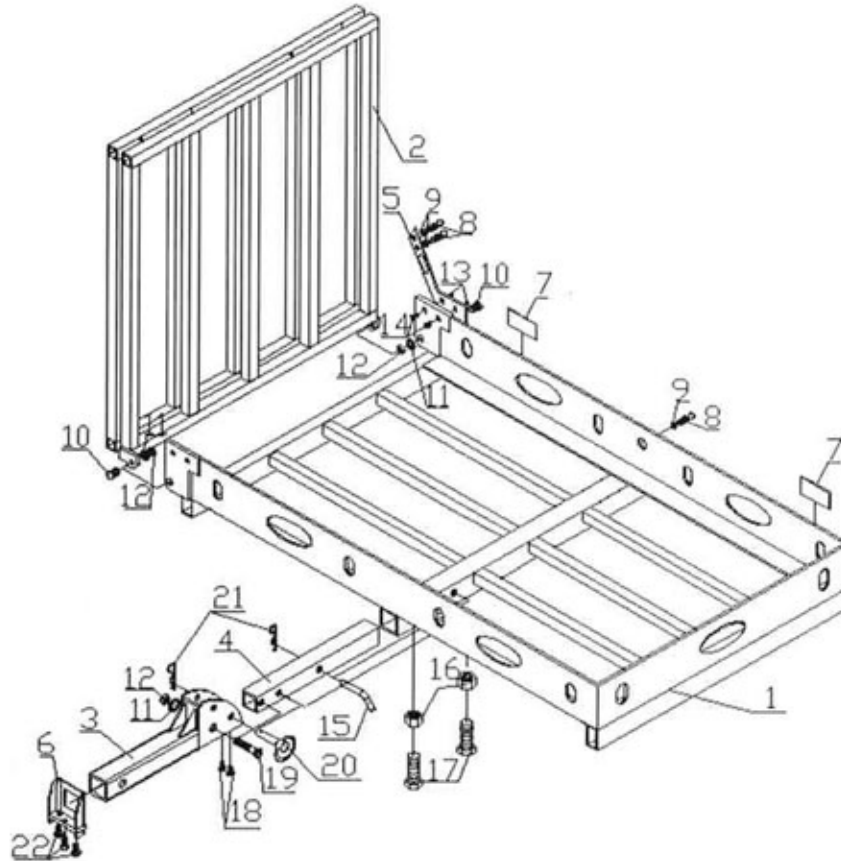

Part No.	Description	Qty
1	Main Frame	1
2	Loading Ramp	1
3	Hitch Tube	1
4	Main Tube	1
5	"L" Plate	1
6	Anti-tile Bracket	1
7	Reflector	2
8	Spring Pull Pin	3
9	Nut M14	3
10	Bolt M12×25	2
11	Washer M12	3
12	Lock Nut M12	3
13	Lock Nut M8	2
14	Screw M8×20	2
15	Pin Φ12	1
16	Nut M14	2
17	Bolt M14×30	2
18	Nut M10	2
19	Hex Bolt M12×60	1
20	Pin Φ12	1
21	"R" Clip	2
22	Bolt M10×30	5

Assembly Instructions

Tools Need:

- 5/8" wrench
- 1/2" wrench
- 3/4" wrench
- 9/16" wrench
- Phillips screwdriver

Step.1

Insert the hitch bar into the carrier rack as shown.

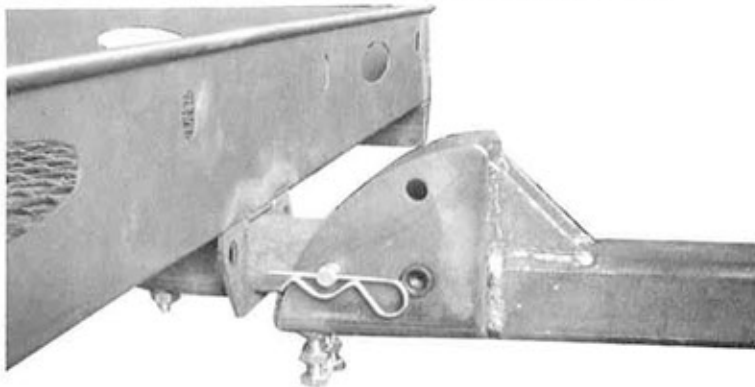

Step.2

Attach the nuts M14 (part #16) on the bolts M14x30 (part #17), then insert the bolts into the holes in the carrier tube, tighten the bolts firmly with a wrench.

Then insert the Pin (part #15) through the holes in the carrier tube and the hitch bar, attach the "R" clip on the Pin to lock the 2 tubes. See the following figures.



Step.3

Insert two bolts M10X30 (part #22) on the bottom of your hitch tube. Tighten bolts firmly with a wrench. See the figure.

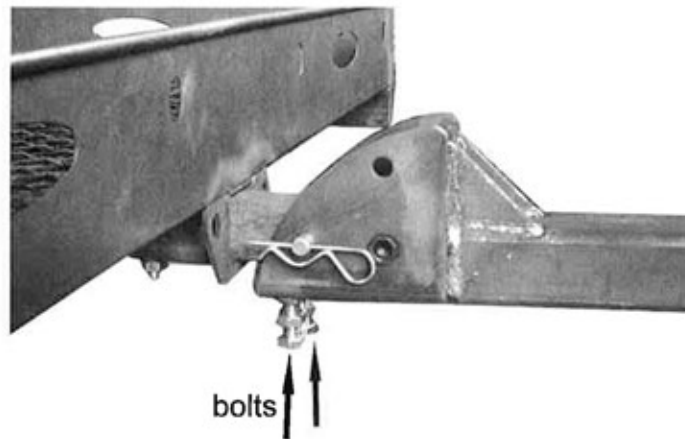

Step.4

Screw spring pull pin into carrier.

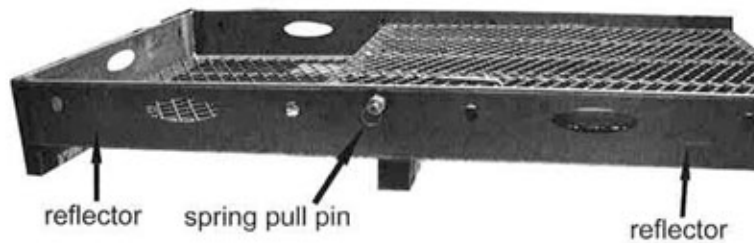

Step.5

Mount the ramp bracket on to the frame by using 2 screws M8X20 (part #14) and the lock nuts M8 (part #13), tighten the nuts firmly with a wrench. Screw two spring pull pin into 2 holes in ramp bracket. See the figures.

NOTE! To prevent loosening of the spring pull pin, torque the jam nut tightly against the ramp bracket.



When in use:

Use safety pin to fold / unfold the platform.

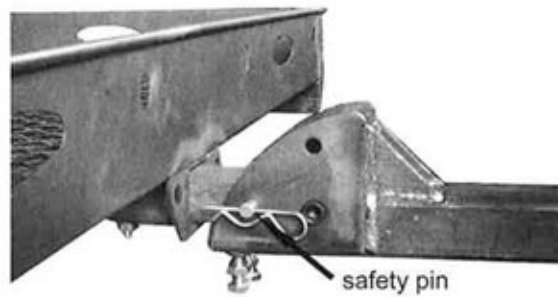

Insert the spring pull pins into the two holes on the ramp when you stand the ramp upright. See the figure.



ATTENTION!

For the first installation of the anti-tilt lock bracket insert the carrier into the hitch receiver. Do not insert the hitch pin at this point. Now slide the carrier toward the vehicle until it holds the anti-tilt lock bracket while an additional person holds the carrier securely against the hitch receiver.

BE SURE TO TORQUE THE BOLTS TO 35-40FT LBS.

**Anti-Tilt
Locking Device**

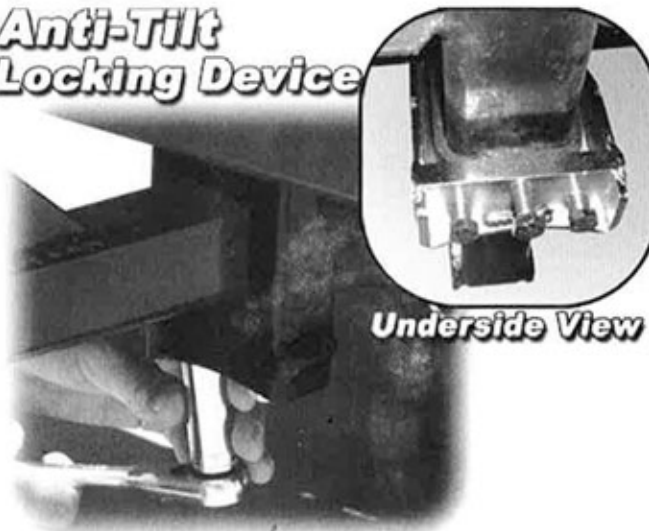

Underside View